

Order Form

Made-to-Length 65mm Linear Drainage



Product Details

Product Code 65AAi25MTL

Grate Style Wave Grate

Stormtech Range 65

Material Stainless Steel Channel

Material Aluminium Grate

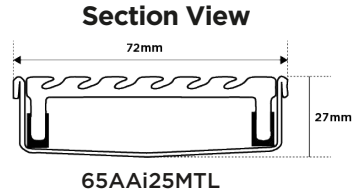

Finish / Code

- Standard / Satin 65AAi25MTL
- Matte Black 65AAi25MTL-Black
- Beach Gold 65AAi25MTL-BG

Please note: Only Aluminium grate is finished, channel is stainless steel

Specify Length, Outlet Size and Position

1. Label



Outlet Size

- 38mm 44mm
- 51mm 63mm
- 76mm 89mm

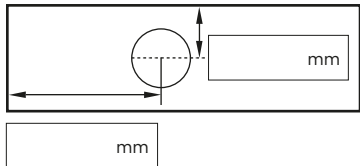

Notes

2. Label



Outlet Size

- 38mm 44mm
- 51mm 63mm
- 76mm 89mm

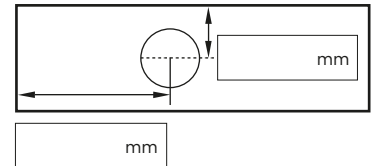

Notes

3. Label



Outlet Size

- 38mm 44mm
- 51mm 63mm
- 76mm 89mm

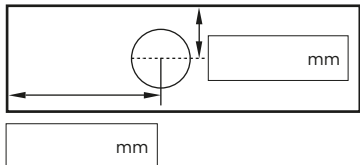

Notes

4. Label



Outlet Size

- 38mm 44mm
- 51mm 63mm
- 76mm 89mm

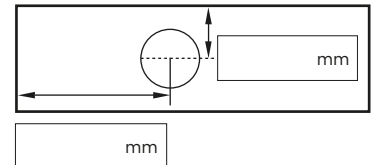

Notes

5. Label



Outlet Size

- 38mm 44mm
- 51mm 63mm
- 76mm 89mm

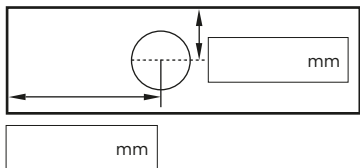

Notes

6. Label



Outlet Size

- 38mm 44mm
- 51mm 63mm
- 76mm 89mm

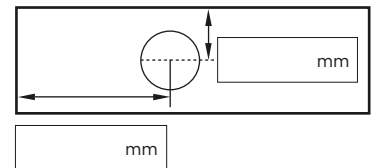

Notes

PLEASE NOTE See AS3500 standard & local regulator for specific outlet/drain requirements. Grates longer than 1500mm are supplied in multiple sections. Channels are a maximum 3000mm in one piece, channels over 3000mm are supplied in multiple sections with joiner. +/- 2mm tolerance on dimensions.

Full Name

Company Name

Project Name / Project Stage

Distributor or Contact

Telephone or Email

Order Number

Stormtech Quote Number

Phone 1300 653 403 | Fax 02 4423 5552

Email info@stormtech.com.au



stormtech.com.au